

CERMISEP KA

MINERAL OIL BASED MOLD RELEASE AGENT



White



- Ready to use
- Allows the mold to be separated from the concrete more easily
- Easy to apply

- Extending the service life of the mold
- Ensuring smooth surface concrete

PRODUCT INFORMATION

WHERE TO USE

• It is used in cases where it is desired to increase mold efficiency in plastic, ply-wood molds and to accelerate mold workmanship.

GENERAL FEATURES

Structure	: Fluidized liquid for wood type molds, consisting of a mixture of high quality lubricants, emulsifiers and special additives
Color	: White
Density	: $0,96 \pm 0,5 \text{ g/cm}^3$



STANDARDS AND DOCUMENTS

- Public Works pos. no. 04.116/1

CONSUMPTION

- Average: 0.05-0.10 kg/m²

PACKAGING

- 20 kg plastic drum

STORAGE

- It should be stored in moisture-free, dry and protected against external weather conditions.
- Shelf life is 1 year under appropriate storage conditions.
- Opened packages should be kept tightly closed.

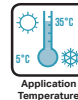

Application Temperature



Application with Brush-Roller

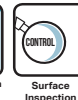

Surface Inspection

CERMISEP KA

APPLICATION

APPLICATION PROCEDURE

Application temperature : +5°C, +35°C

SUBSTRATE PREPARATION

• Before using **CERMISEP KA**, the molds must be dry, clean and free of concrete and rust residues.

APPLICATION

- **CERMISEP KA** is ready for use and must be mixed before use.
- It can be applied to the clean mold surface with a roller, brush or sprayer.
- For maximum performance, the product should be applied homogeneously and thinly.
- Very absorbent and old molds may require a 2nd coat.

RECOMMENDATIONS

- Water should not be added before and after use.

SAFETY INSTRUCTIONS

- Do not inhale, avoid contact with skin and eyes.
- It is recommended to use appropriate work equipment (gloves, goggles, mask, knee pads, etc.) during product application.
- For more detailed information please read the Material Safety Data Sheet (MSDS).

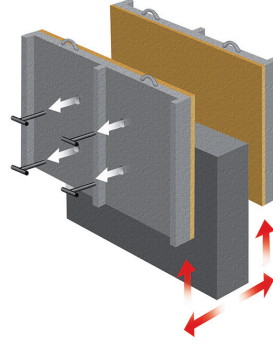

Note: Technical values and application instructions are valid under ambient temperature of 23°C with relative humidity 50% and they are the results of our tests and experience in accordance with international standards. Our company is not responsible for any errors that may occur if the instructions and recommendations specified in the technical data sheets are not followed.

CERMIX

CERMIX Produced by Koramic Yapı Kimyasalları under license of Cermix SA. www.cermix.com.tr * www.koramic.com.tr

Head Office
Koramic Yapı Kimyasalları San. Tic. A.Ş.
E-5 Karayolu Üzeri, Şifa Mah. Hükümet Cad.
Tuzla 34941 İstanbul / TÜRKİYE
Phone: +90.216.423 34 33 • Fax: +90.216.423 53 63

Bozüyük Factory
Bozüyük Organize San. Böl. 10. Cad.
106 Ada / 5 Parsel No: 3 Bozüyük - BİLEÇİK / TÜRKİYE
Phone: +90.228.314 63 00
Fax: +90.228.314 63 00

Tarsus Factory
Huzurkent Tarsus Organize Sanayi Bölgesi
13. Cadde No: 10 Tarsus - MERSİN / TÜRKİYE
Phone: +90.324.676 40 41-676 42 32-676 44 49
Fax: +90.324.676 40 47